

## GE STAINLESS STEEL STRAIGHT MALE STUD CONNECTOR (R THREAD)

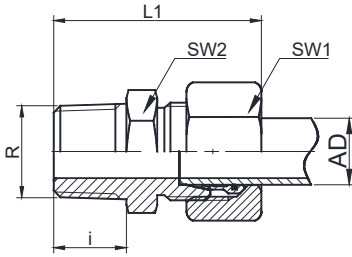

Bite Type Fitting

**Ordering Information:** E-GE-L12R1/2K-SS (high pressure)  
B-GE-L12R1/2K-SS (corrosion-resistant)

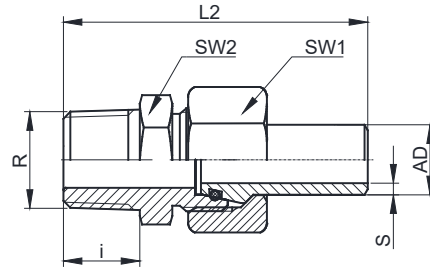

Weld Fitting

**Ordering Information:** W-GE-L12R1/2K-SS

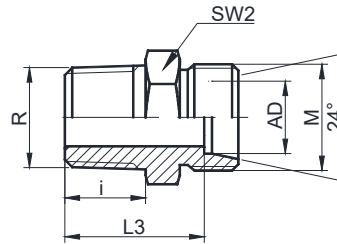

Body

**Ordering Information:** GE-L12R1/2K-SS

Series	Bite Type	Weld Type	Body Ordering Number	AD	S	R	L1	L2	L3	i	SW1	SW2	M	
L	E-	B-	W-	GE-L06R1/8K-SS	6	1.5	R1/8K	31.5	49.0	17.0	10.0	14	14	M12*1.5
	E-	B-	W-	GE-L06R1/4K-SS			R1/4K	35.5	53.0	21.0	12.0	14	17	
	E-	B-	W-	GE-L08R1/4K-SS	8	1.5	R1/4K	36.0	53.0	21.0	12.0	17	17	M14*1.5
	E-	B-	W-	GE-L08R3/8K-SS			R3/8K	36.0	53.0	21.0	12.5	17	19	
	E-	B-	W-	GE-L10R1/4K-SS	10	1.5	R1/4K	36.5	54.5	22.0	12.0	19	17	M16*1.5
	E-	B-	W-	GE-L10R3/8K-SS			R3/8K	36.5	54.5	22.0	12.5	19	19	
	E-	B-	W-	GE-L12R1/4K-SS	12	1.5	R1/4K	38.0	56.0	23.0	12.0	22	19	M18*1.5
	E-	B-	W-	GE-L12R3/8K-SS			R3/8K	38.0	56.0	23.0	12.5	22	19	
	E-	B-	W-	GE-L12R1/2K-SS			R1/2K	41.0	59.0	26.0	15.0	22	24	
	E-	B-	W-	GE-L15R1/2K-SS	15	2.0	R1/2K	43.5	64.0	27.0	15.0	27	24	M22*1.5
	E-	B-	W-	GE-L18R1/2K-SS	18	2.5	R1/2K	45.0	65.5	27.0	15.0	32	27	M26*1.5
	E-	B-	W-	GE-L18R3/4K-SS			R3/4K	47.5	68.0	29.5	17.0	32	27	
	E-	B-	W-	GE-L22R3/4K-SS	22	3.0	R3/4K	49.0	71.5	31.5	17.0	36	32	M30*2
	E-	B-	W-	GE-L28R1K-SS	28	4.0	R1K	54.5	78.5	35.5	19.0	41	41	M36*2
	E-	B-	W-	GE-L35R11/4K-SS	35	4.0	R11/4K	61.0	86.5	37.5	22.0	50	46	M45*2
	E-	B-	W-	GE-L42R11/2K-SS	42	5.0	R11/2K	64.0	89.0	40.0	24.0	60	55	M52*2
-	-	W-	GE-L48R11/2K-SS	48	5.0	R11/2K	-	98.0	48.0	24.0	65	60	M58*2	
-	-	W-	GE-L60R2K-SS	60	6.0	R2K	-	116.0	57.0	27.0	80	75	M72*2	
S	E-	-	W-	GE-S12R3/8K-SS	12	2.0	R3/8K	43.5	61.0	27.5	12.5	24	22	M20*1.5
	E-	-	W-	GE-S14R1/2K-SS	14	2.0	R1/2K	46.5	68.0	28.5	15.0	27	24	M22*1.5
	E-	-	W-	GE-S16R1/2K-SS	16	2.5	R1/2K	51.0	72.0	31.5	15.0	30	27	M24*1.5
	E-	-	W-	GE-S20R3/4K-SS	20	3.0	R3/4K	55.5	82.0	35.5	17.0	36	32	M30*2

Note: All the materials listed above are 304 stainless steel. For 316L stainless steel, change "-SS" to "SL". The standard sealing material is FPM.