

## GE STAINLESS STEEL STRAIGHT MALE STUD CONNECTOR (G THREAD)

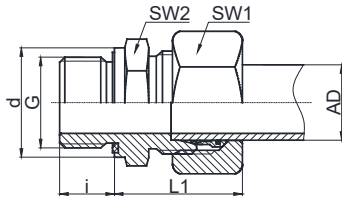

Bite Type Fitting

**Ordering Information:** E-GE-L22G3/4WD-SS (high pressure)  
B-GE-L22G3/4WD-SS (corrosion-resistant)

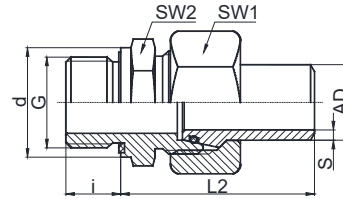

Weld Fitting

**Ordering Information:** W-GE-L22G3/4WD-SS

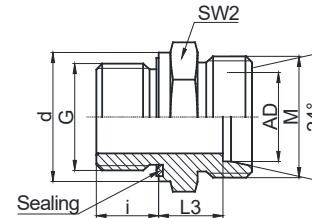

Body

**Ordering Information:** GE-L22G3/4WD-SS

Series	Bite Type		Weld Type	Body Ordering Number	AD	G	S	L1	L2	L3	d	i	SW1	SW2	M
	E-	B-													
L	E-	B-	W-	GE-L06G1/8WD-SS	6	G1/8	1.5	23.0	40.5	8.5	14.0	8	14	14	M12*1.5
	E-	B-	W-	GE-L06G1/4WD-SS		G1/4		24.5	42.0	10.0	18.9	12	14	19	
	E-	B-	W-	GE-L08G1/8WD-SS	8	G1/8	1.5	24.0	41.5	9.5	14.0	8	17	14	M14*1.5
	E-	B-	W-	GE-L08G1/4WD-SS		G1/4		24.5	42.0	10.0	18.9	12	17	19	
	E-	B-	W-	GE-L08G3/8WD-SS		G3/8		26.0	43.0	11.5	22.0	12	17	22	
	E-	B-	W-	GE-L08G1/2WD-SS		G1/2		26.5	44.0	12.0	27.0	14	17	27	
	E-	B-	W-	GE-L10G1/4WD-SS	10	G1/4	1.5	25.5	43.5	11.0	18.9	12	19	19	M16*1.5
	E-	B-	W-	GE-L10G3/8WD-SS		G3/8		27.0	45.0	12.5	22.0	12	19	22	
	E-	B-	W-	GE-L10G1/2WD-SS	12	G1/2	1.5	27.5	45.5	13.0	26.9	14	19	27	M18*1.5
	E-	B-	W-	GE-L12G1/4WD-SS		G1/4		27.0	45.5	12.5	18.9	12	22	19	
	E-	B-	W-	GE-L12G3/8WD-SS		G3/8		27.0	45.5	12.5	22.0	12	22	22	
	E-	B-	W-	GE-L12G1/2WD-SS		G1/2		27.5	46.0	13.0	26.9	14	22	27	
	E-	B-	W-	GE-L12G3/4WD-SS	15	G3/4	2.0	28.5	47.0	14.0	32.0	16	22	32	M22*1.5
	E-	B-	W-	GE-L15G3/8WD-SS		G3/8		30.0	50.5	13.5	22.0	12	27	24	
	E-	B-	W-	GE-L15G1/2WD-SS	18	G1/2	2.5	30.5	51.0	14.0	26.9	14	27	27	M26*1.5
	E-	B-	W-	GE-L15G3/4WD-SS		G3/4		31.5	52.0	15.0	32.0	16	27	32	
	E-	B-	W-	GE-L18G3/8WD-SS		G3/8		32.0	53.0	14.5	21.9	12	32	27	
	E-	B-	W-	GE-L18G1/2WD-SS	22	G1/2	3.0	32.0	53.0	14.5	26.9	14	32	27	M30*2
	E-	B-	W-	GE-L18G3/4WD-SS		G3/4		32.0	53.0	14.5	32.0	16	32	32	
	E-	B-	W-	GE-L22G1/2WD-SS		G1/2		34.0	56.5	16.5	27.0	14	36	32	
	E-	B-	W-	GE-L22G3/4WD-SS	28	G3/4	4.0	34.0	56.5	16.5	32.0	16	36	32	M36*2
	E-	B-	W-	GE-L22G1WD-SS		G1		35.0	57.5	17.5	40.0	18	36	41	
	E-	B-	W-	GE-L28G3/4WD-SS	35	G3/4	4.0	36.0	58.0	17.5	32.0	16	41	38	M45*2
	E-	B-	W-	GE-L28G1WD-SS		G1		36.0	61.5	17.5	39.9	18	41	41	
E-	B-	W-	GE-L28G11/4WD-SS	G11/4		37.0		62.5	18.5	49.9	20	41	50		
E-	B-	W-	GE-L35G11/4WD-SS	42	G11/4	5.0	41.0	66.5	17.5	49.9	20	50	50	M52*2	
E-	B-	W-	GE-L35G11/2WD-SS		G11/2		42.5	68.0	19.0	55.0	22	50	55		
E-	B-	W-	GE-L42G11/4WD-SS	48	G11/4	5.0	43.0	68.0	19.0	50.0	20	60	55	M58*2	
E-	B-	W-	GE-L42G11/2WD-SS		G11/2		43.0	68.0	19.0	55.0	22	60	55		
-	-	W-	GE-L48G11/2WD-SS	60	G11/2	5.0	-	78.0	28.0	55.0	22	65	60	M72*2	
-	-	W-	GE-L60G2WD-SS	60	G2	6.0	-	98.0	34.0	70.0	24	80	75	M72*2	

Note: All the materials listed above are 304 stainless steel. For 316L stainless steel, change "-SS" to "SL". The standard sealing material is FPM.

## GE STAINLESS STEEL STRAIGHT MALE STUD CONNECTOR (G THREAD)

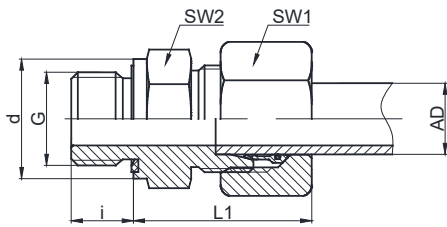

Bite Type Fitting

Ordering Information: E-GE-S16G1/2WD-SS (high pressure)

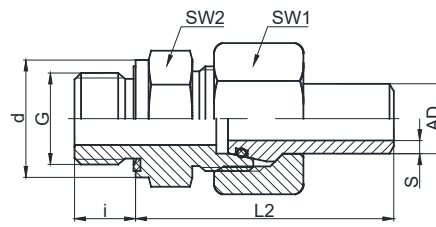

Weld Fitting

Ordering Information: W-GE-S16G1/2WD-SS

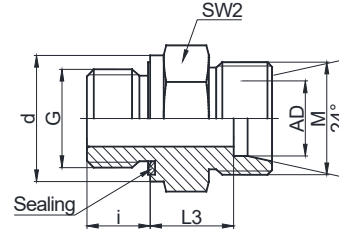

Body

Ordering Information: GE-S16G1/2WD-SS

Series	Bite Type	Weld Type	Body Ordering Number	AD	G	S	L1	L2	L3	d	i	SW1	SW2	M
S	E-	W-	GE-S06G1/4WD-SS	6	G1/4	1.5	27.5	45.0	13.0	18.9	12	17	19	M14*1.5
	E-	W-	GE-S08G1/4WD-SS	8	G1/4	1.5	30.0	47.0	15.0	18.9	12	19	19	M16*1.5
	E-	W-	GE-S08G3/8WD-SS		G3/8		30.0	47.0	15.0	22.0	12	19	22	
	E-	W-	GE-S10G1/4WD-SS	10	G1/4	2.0	30.5	47.5	14.5	18.9	12	22	22	M18*1.5
	E-	W-	GE-S10G3/8WD-SS		G3/8		31.0	48.0	15.0	22.0	12	22	22	
	E-	W-	GE-S12G1/4WD-SS	12	G1/4	2.0	32.5	50.0	16.5	18.9	12	24	22	M20*1.5
	E-	W-	GE-S12G3/8WD-SS		G3/8		33.0	50.5	17.0	22.0	12	24	22	
	E-	W-	GE-S12G1/2WD-SS		G1/2		33.5	51.0	17.5	26.9	14	24	27	
	E-	W-	GE-S14G3/8WD-SS	14	G3/8	2.0	36.0	57.5	18.0	21.9	12	27	24	M22*1.5
	E-	W-	GE-S14G1/2WD-SS		G1/2		37.0	58.5	19.0	26.9	14	27	27	
	E-	W-	GE-S16G3/8WD-SS	16	G3/8	2.5	37.5	58.5	18.0	22.0	12	30	27	M24*1.5
	E-	W-	GE-S16G1/2WD-SS		G1/2		38.0	59.0	18.5	26.9	14	30	27	
	E-	W-	GE-S16G3/4WD-SS		G3/4		40.0	61.0	20.5	32.0	16	30	32	
	E-	W-	GE-S20G1/2WD-SS	20	G1/2	3.0	40.5	66.5	20.5	26.9	14	36	32	M30*2
	E-	W-	GE-S20G3/4WD-SS		G3/4		40.5	66.5	20.5	32.0	16	36	32	
	E-	W-	GE-S20G1WD-SS		G1		40.5	66.5	20.5	40.0	18	36	41	
	E-	W-	GE-S25G3/4WD-SS	25	G3/4	4.0	48.0	75.0	23.0	32.0	16	46	41	M36*2
	E-	W-	GE-S25G1WD-SS		G1		48.0	75.0	23.0	39.9	18	46	41	
	E-	W-	GE-S30G1WD-SS	30	G1	4.0	51.0	79.5	23.5	40.0	18	50	46	M42*2
	E-	W-	GE-S30G11/4WD-SS		G11/4		51.0	79.5	23.5	49.9	20	50	50	
E-	W-	GE-S38G11/2WD-SS	38	G11/2	5.0	58.5	88.0	26.0	55.0	22	60	55	M52*2	
-	W-	GE-S50G2WD-SS	50	G2	7.0	-	98.5	32.0	69.9	24	80	70	M68*2	

Note: All the materials listed above are 304 stainless steel. For 316L stainless steel, change "-SS" to "SL". The standard sealing material is FPM.