

GE STAINLESS STEEL STRAIGHT MALE STUD CONNECTOR (M THREAD)

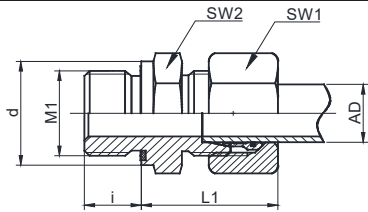

Bite Type Fitting

Ordering Information: E-GE-L06M10*1WD-SS (high pressure)
B-GE-L06M10*1WD-SS (corrosion-resistant)

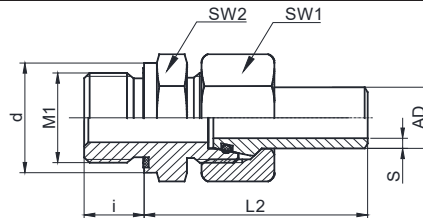

Weld Fitting

Ordering Information: W-GE-L06M10*1WD-SS

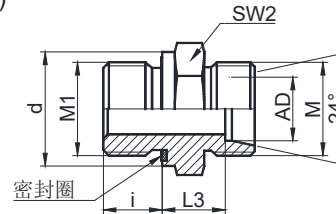

Body

Ordering Information: GE-L06M10*1WD-SS

Series	Bite Type	Weld Type	Body Ordering Number	AD	M1	S	L1	L2	L3	d	i	SW1	SW2	M	
L	E-	B-	W-	GE-L06M10*1WD-SS	6	M10*1	1.5	23.0	40.5	8.5	14.0	8	14	14	M12*1.5
	E-	B-	W-	GE-L08M12*1.5WD-SS	8	M12*1.5	1.5	25.0	42.0	10.0	17.0	12	17	17	M14*1.5
	E-	B-	W-	GE-L08M14*1.5WD-SS		M14*1.5		26.0	43.0	11.0	19.0	12	17	19	
	E-	B-	W-	GE-L10M12*1.5WD-SS	10	M12*1.5	1.5	25.5	43.5	11.0	17.0	12	19	17	M16*1.5
	E-	B-	W-	GE-L10M14*1.5WD-SS		M14*1.5		25.5	43.5	11.0	19.0	12	19	19	
	E-	B-	W-	GE-L10M16*1.5WD-SS		M16*1.5		27.0	45.0	12.5	21.9	12	19	22	
	E-	B-	W-	GE-L10M18*1.5WD-SS		M18*1.5		27.0	45.0	12.5	23.9	12	19	24	
	E-	B-	W-	GE-L12M14*1.5WD-SS	12	M14*1.5	1.5	27.5	45.5	12.5	18.9	12	22	19	M18*1.5
	E-	B-	W-	GE-L12M16*1.5WD-SS		M16*1.5		27.5	45.5	12.5	21.9	12	22	22	
	E-	B-	W-	GE-L12M18*1.5WD-SS		M18*1.5		27.5	45.5	12.5	23.9	12	22	24	
	E-	B-	W-	GE-L12M22*1.5WD-SS		M22*1.5		29.0	47.0	14.0	27.0	14	22	27	
	E-	B-	W-	GE-L15M18*1.5WD-SS	15	M18*1.5	2.0	30.0	50.5	13.5	23.9	12	27	24	M22*1.5
	E-	B-	W-	GE-L15M22*1.5WD-SS		M22*1.5		31.5	52.0	15.0	27.0	14	27	27	
	E-	B-	W-	GE-L18M18*1.5WD-SS	18	M18*1.5	2.5	32.0	51.5	14.5	23.9	12	32	27	M26*1.5
	E-	B-	W-	GE-L18M22*1.5WD-SS		M22*1.5		32.0	51.5	14.5	27.0	14	32	27	
	E-	B-	W-	GE-L22M26*1.5WD-SS	22	M26*1.5	3.0	34.0	56.5	16.5	31.9	16	36	32	M30*2
E-	B-	W-	GE-L28M33*2WD-SS	28	M33*2	4.0	36.0	60.5	17.5	39.9	18	41	41	M36*2	
E-	B-	W-	GE-L35M42*2WD-SS	35	M42*2	4.0	41.0	66.0	17.5	49.9	20	50	50	M45*2	
E-	B-	W-	GE-L42M48*2WD-SS	42	M48*2	5.0	43.0	68.0	19.0	55.0	22	60	55	M52*2	
S	E-	-	W-	GE-S06M12*1.5WD-SS	6	M12*1.5	1.5	27.5	45.0	13.0	17.0	12	17	17	M14*1.5
	E-	-	W-	GE-S08M14*1.5WD-SS	8	M14*1.5	1.5	30.0	47.0	15.0	19.0	12	19	19	M16*1.5
	E-	-	W-	GE-S10M16*1.5WD-SS	10	M16*1.5	2.0	31.0	47.0	15.0	21.9	12	22	22	M18*1.5
	E-	-	W-	GE-S12M18*1.5WD-SS	12	M18*1.5	2.0	33.0	50.0	17.0	23.9	12	24	24	M20*1.5
	E-	-	W-	GE-S14M20*1.5WD-SS	14	M20*1.5	2.0	37.0	58.5	19.0	25.9	14	27	27	M22*1.5
	E-	-	W-	GE-S16M18*1.5WD-SS	16	M18*1.5	2.5	37.5	58.5	18.0	23.0	12	30	27	M24*1.5
	E-	-	W-	GE-S16M22*1.5WD-SS		M22*1.5		38.0	59.0	18.5	27.0	14	30	27	
	E-	-	W-	GE-S20M27*2WD-SS	20	M27*2	3.0	40.5	66.5	20.5	32.0	16	36	32	M30*2
	E-	-	W-	GE-S25M33*2WD-SS	25	M33*2	4.0	48.0	75.0	23.0	39.9	18	46	41	M36*2
	E-	-	W-	GE-S30M42*2WD-SS	30	M42*2	4.0	51.0	79.5	23.5	49.9	20	50	50	M42*2
	E-	-	W-	GE-S38M48*2WD-SS	38	M48*2	5.0	59.0	88.0	26.0	55.0	22	60	55	M52*2

Note: All the materials listed above are 304 stainless steel. For 316L stainless steel, change "-SS" to "SL". The standard sealing material is FPM.